

Cable feedthrough with heat shrink boot 207W213 to 207W264

These cable entry feedthroughs provides protection through bulkheads, panels and similar applications. The Cable feedthroughs 207W213 to 207W264 provide an effective pressure seal when used with cables passing from pressurised to non-pressurised areas. These products offers excellent strain relief and bulkhead abrasion protection.

As supplied

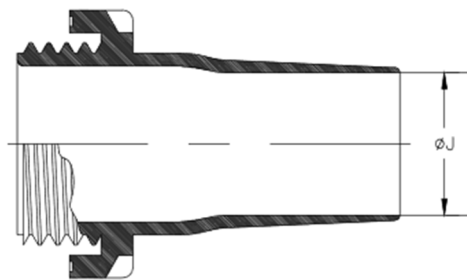

After heating

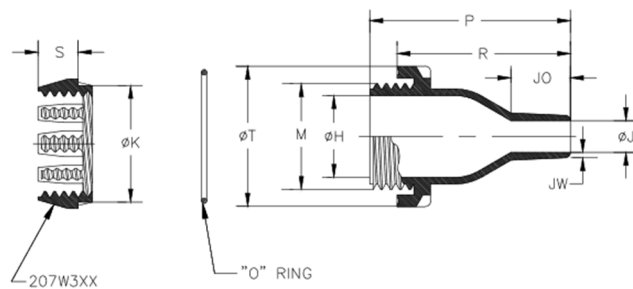

Dimensions in mm

Part Number	Inside diameter (coating reduces ϕ max. 1.5mm)				P	R	S	T	JO	K	M
	As supplied		After heating								
	H	J	H	J							
207W213	12.0	10.0	12.0	4.0	62.0	49.0	13.0	32.0	15.3	23.0	20.0
207W223	20.0	18.0	20.0	7.0	72.0	59.0	16.0	42.0	19.5	33.0	30.0
207W234	31.0	28.0	31.0	12.0	87.0	74.0	18.0	58.0	27.0	46.0	42.0
207W245	45.0	42.0	45.0	18.0	102.0	89.0	18.0	71.0	32.2	59.5	56.0
207W258	68.0	64.0	68.0	30.0	122.0	109.0	18.0	97.0	39.0	84.0	80.0
207W264	40.0	38.0	40.0	15.0	82.0	82.0	18.0	66.5	28.3	54.0	50.0

Material (not all combinations available)

Ordering Code	Material	Operating temperature range
-3	Polyolefin, semi-rigid	-55°C to +135°C
-4	Polyolefin, flexible	-55°C to +135°C
-12	Fluoroelastomer, flexible	-55°C to +200°C
-25	Elastomer, fluid resistant	-75°C to +150°C
-100	Polyolefin, halogen free	-30°C to +105°C

Coating, Adhesive

Ordering code	Material	Operating temperature range
/42	Polyamide, hot-melt	-20°C to +60°C
/86	High performance, hot-melt	-55°C to +120°C
/225	Epoxy/Polyamide	-75°C to +150°C

Colour

Ordering Code	Colour
-0	Black